

Forestry tracks and forestry chains

for forestry machinery & tractors



Why opt for pewag?

pewag forestry tracks: Your reliable partners for challenging tasks

Case-hardened link system

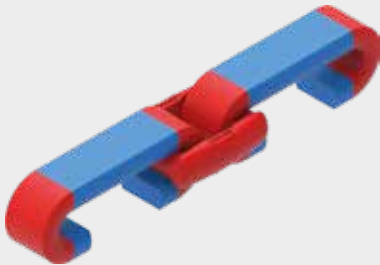

Maximum wear resistance, resulting in a long component lifespan.



Reduced track elongation minimises the need for re-tensioning.

Optimised track design

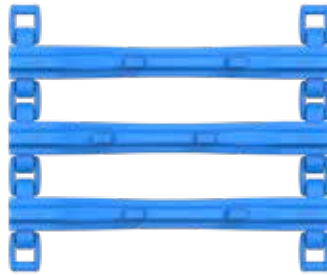

Different lock sizes for flexible length adjustment.



pewag tracks are designed in such a way as to prevent unnecessary strain being placed on the double axles, helping to protect your machinery.

Unique starwave® stubs

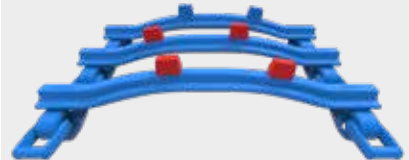

Increased driving comfort thanks to bespoke 2x2 offset stub design.

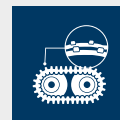

Two offset stubs are standard for all our chains and ensure greater stability and (lateral) grip.

pewag forestry chains: Experience garnered over centuries

Long lifespan



Thanks to titangrip®, the pewag special steel, our chains are particularly wear-resistant and long-lasting.



The chains fit the tyre precisely and prevent slipping.



pewag expertise



Excellent self-cleaning properties



Chains are prevented from sliding, reducing damage to machinery and tyres.



Excellent grip

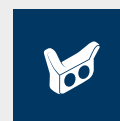

Innovative traction elements ensure superior grip and stability for our chains.

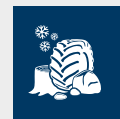

Our product range has the perfect solution for every tyre and situation.



Introduction

Dear customer,

pewag is your reliable partner for professional forestry applications. Our forestry tracks are made according to the same principles as our forestry chains: state-of-the-art technology that withstands even the toughest conditions.

pewag manufactured its first snow chain back in 1912. Since then, our company has made a name for itself as one of the leading brands in the industry, both in terms of quality and of wear resistance. The forestry tracks we now offer for forestry machinery have the same outstanding characteristics as our forestry chains: outstanding wear resistance, robustness and value for money. Thanks to their reduced impact on the soil, pewag forestry tracks are also an environmentally friendly alternative.

pewag has been manufacturing high-quality chains for more than 500 years. Our history goes back all the way to 1479, when the first forge started operating in Brückl. Over the centuries, pewag has established itself as a leading global supplier, with a wealth of international subsidiaries.

High standards have always been our strength, both in the manufacturing process and in the selection of raw materials. To ensure the outstanding quality of our range, all our production facilities are still based in Central Europe. This allows us to keep an overview of the entire manufacturing process and to offer forestry tracks and chains that create innovative solutions while also living up to the highest quality standards.



pewag starwave® technology offers improved traction, increased wear volume and a longer lifespan due to the larger surface of the stub.



pewag titangrip® special alloy, combined with a special heat treatment process, ensures maximum wear resistance.



To ensure outstanding product quality, all our production facilities are still based in Central Europe. This allows us to control the entire manufacturing process and to offer forestry tracks and chains that create innovative solutions while also living up to the highest quality standards.



Technical changes and misprints excepted.
Printed on environmentally friendly paper.

Publishing details:

Media owner: pewag Schneeketten GmbH, 8041 Graz, Austria
Printed by: Universitätsdruckerei Klampfer GmbH, 8181 St. Ruprecht an der Raab, Austria
Version: Edition 2024

pewag group

We are part of the pewag group 4–5

pewag forestry tracks:

pewag forestry tracks – cut-to-length harvesting method	8
pewag forestry tracks for forwarders and harvesters	9
pewag practrack	10
pewag practrack - overview	12–13
pewag bluetrack	14
pewag blutracks - overview	16–17
pewag bluetrack+	18
pewag suptrack	20
pewag suptracks - overview	22–23
pewag forestry tracks – full-tree-length harvesting method	24
pewag mono skidder	25

pewag forestry chains:

pewag forestry chains – overview	27
pewag forestry chains Matrix	28–29
pewag forstgrip	30
pewag forstgrip pro	31
pewag forstgrip cross	32
pewag forstgrip soft	33
pewag forstgrip pro soft	34
pewag prac chain 16 & 18	35

We are part of the **pewag group**

pewag forestry is part of an internationally operating group of companies. Our success story goes back to the year 1479.

WHAT DRIVES US

Through our entrepreneurial spirit - shaped by the joy of innovation - we strive to offer the best solutions for the market. Today and in the future.

The high quality of our brands, products and services, as well as the passionate commitment of our employees are our most valuable assets to exceed customer expectations and to live up to our corporate responsibility towards people and environment.

LEADING TO EXCELLENCE



striving for excellence in **QUALITY**

The values of the pewag group brands are demonstrated by our first-class quality and continuous innovation. You can rely on us.



striving for excellence in **RESPONSIBILITY**

Our goal is CO₂ neutral production by 2030. We live sustainable and fair partnerships and an open way of working together. We take on social as well as environmental responsibility.



striving for excellence in **ENTREPRENEURSHIP**

Through the specific expertise of each individual and decentralized responsibilities, we ensure healthy growth and a sustainably successful future.



striving for excellence in **TECHNOLOGY**

We ensure our technological strength by striving for quality, continuous improvement and innovation of our products and production processes.

FROM AUSTRIA....



1479

First documentary mention of the forge

1787

Foundation of the chain forge in Kapfenberg

1803

Foundation of the location in Graz

1836

Establishment of an iron casting plant in Brückl

1912

Production of the first pewag snow chain

2009

pewag develops into an international group of companies

2021

Extensive investment in renewable energies. Goal: CO₂-neutral production by 2030

....ACROSS THE GLOBE

100+

Countries

50

Sales and other locations

45

Sales partners

18

Production sites

15+

Brands

5

Continents

IN A SUSTAINABLE WAY

Social Excellence

The corporate ethics of the pewag group are based on our clear commitment to universal human rights. As a globally active group of companies, we bear a social and corporate responsibility. This applies in particular to our employees. Their occupational safety and health protection are our top priority. We promote their personal and professional development and foster a culture of open, honest, non-discriminatory and team-oriented exchange based on transparent communication. We apply the same standards in our dealings with customers, suppliers and other business partners.



Environmental Excellence

We are committed to a careful and sustainable approach to the environment. This applies to all areas and activities of our group of companies. For us, it is a matter of course to use resources as efficiently as possible and to ensure this also in the future through new environmentally friendly and efficient processes. We are continuously working to optimize the durability and recyclability of our products. In this context, one of our core concerns is to continuously improve our energy efficiency and thus reduce energy consumption in the long term. The energy we use comes from renewable energy sources and is already partly generated by ourselves.

WHAT DEFINES US



Snow and forestry chains



Hoist and conveyor chains



Do-it-yourself



Engineering



Lifting solutions



Tire protection chains

Our Expertise.

Our international brands have an extensive and diverse range of products and services.

The portfolio ranges from traction chains for tires, tire protection chains for mining vehicles over a wide range of technical chains and innovative lifting solutions up to products for the do-it-yourself area as well as forming technology.

Our Network.

With over 50 locations on five continents, the pewag group forms a global platform of product specialists, partners and suppliers.

This community is strengthened by a large network of external experts from science, research and development and a wide range of brands and companies within the group.

Our Experience.

Based on centuries of experience, genuine craftsmanship and innovative technologies we process the highest quality materials with the claim to offer the best solutions on the market.

What unites us as people within the pewag group is the strong ambition for continuous development.

pewag perfect extreme

The expert on steep slopes!

For more info on perfect extreme, see page 24.

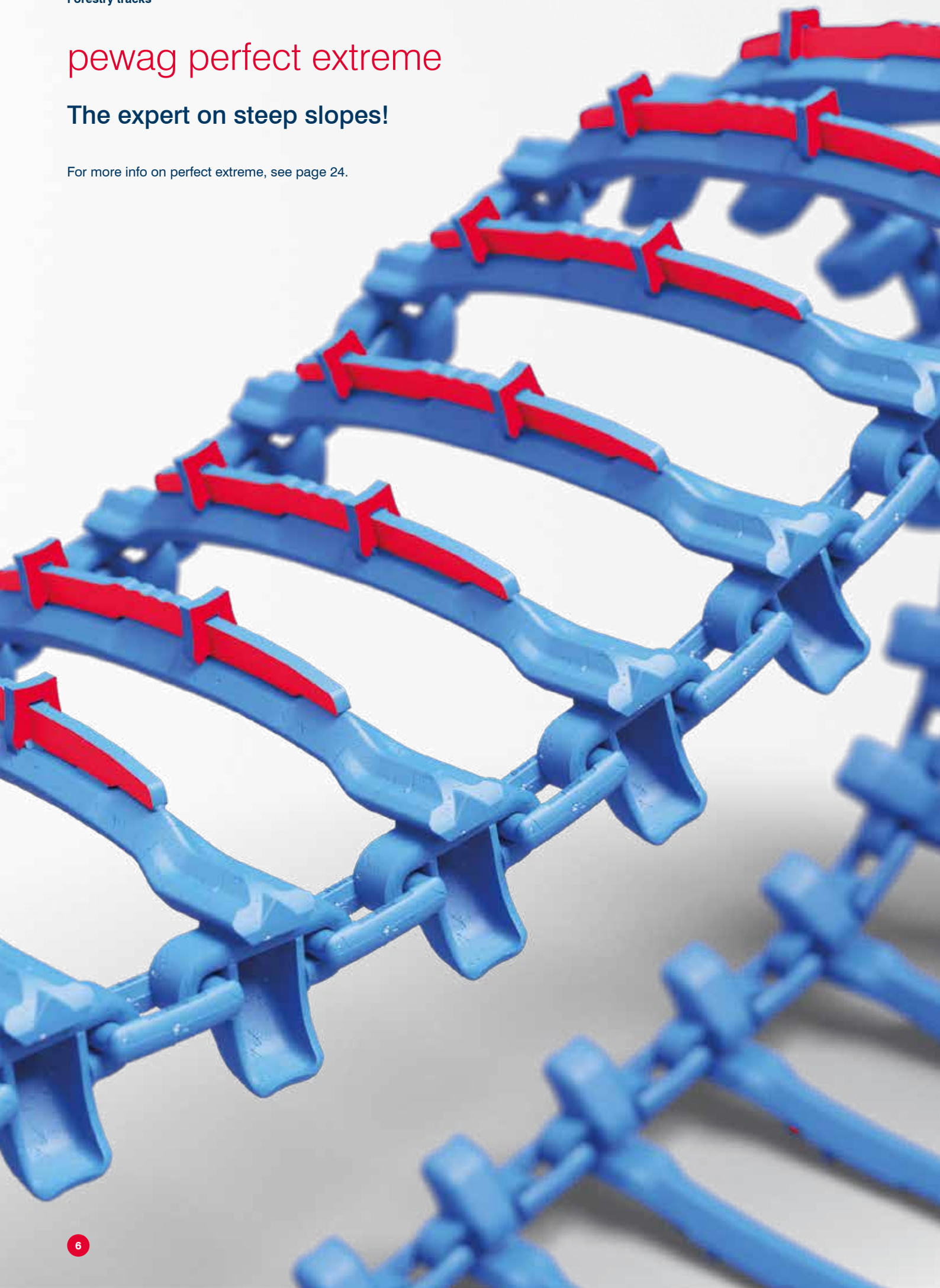

pewag assembly tool PMTU

Safeguarding instead of slogging

Your experts in any situation!

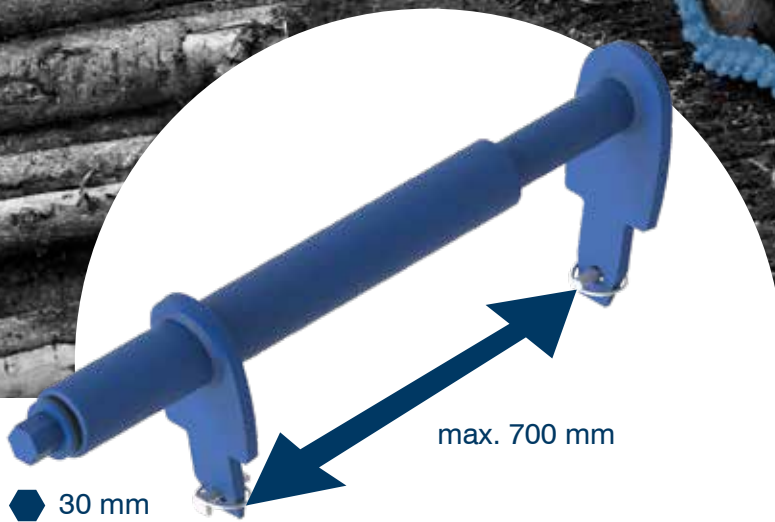

easy



universal



fast

What's in the bag?



Mounting clamps
2x 200 mm & 2x 240 mm



Mounting belt



High-visibility vest



Gloves

PMTU assembly tool

The universal pewag assembly tool for all duo forestry tracks.

With the PMTU, mounting your forestry tracks becomes a piece of cake. Delivered in a handy bag that stores all required tools in one place (impact wrench is not included).

Suitable for all pewag duo forestry tracks.

Forestry tracks

cut-to-length harvesting method



For forwarders and harvesters

pewag offers a wide range of tracks for harvesters and foresters, divided into three product families: **practrac**, **bluetrack** and **suptrack**.

Each family consists of different products. Whether you are looking for an aggressive track suitable for steep slopes or gentle tracks that go easy on the soil, pewag has the right solution for you.

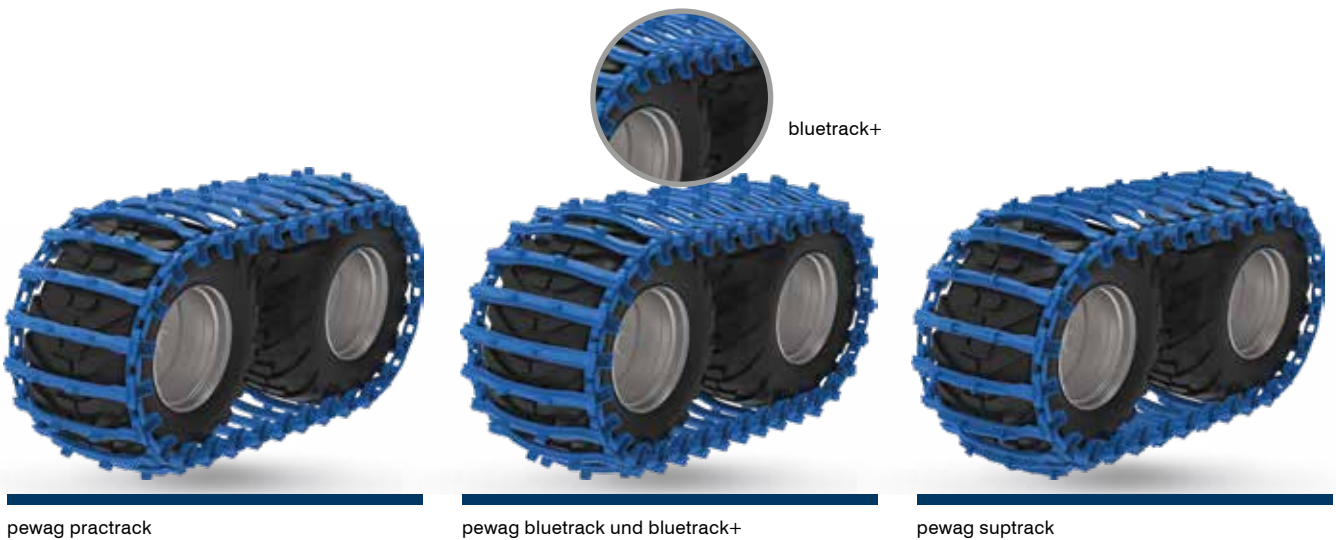

Benefits of pewag forestry tracks:



Improved tyre protection



Higher level of occupational safety



Increased load capacity



Reduced soil impact



The comparison highlights standard soil impact of tyres without tracks and the even load distribution achieved with pewag forestry tracks.

pewag practrack – practical solutions for your harvesting operations

Unsurpassed cost/benefit ratio



pewag practrack perfect – duo with small-wave stub



pewag practrack perfect – mono with small-wave stub



pewag[®] practrack perfect

pewag[®] practrack duro

pewag[®] practrack flow-perfect

pewag[®] practrack flow

pewag[®] practrac flow wide

Link distance: Long (L)



For improved self-cleaning properties and reduced weight

starwave[®] stub: small wave (SW)

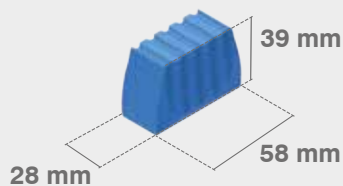

For more traction and improved wear resistance

Case-hardened

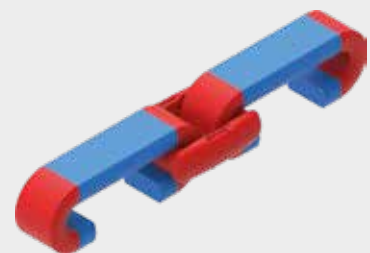

This process increases surface hardness and thus also the wear resistance of the connecting system.



practrack

pewag practrack is the perfect starting product, offering tried-and-tested pewag quality at a great price. This makes the practrack particularly suitable for use with second-hand machinery. As they weigh less than other pewag models, the

practrack is predestined for smaller machines. With two offset starwave® stubs in size S, practrack ensure reliable performance. In addition, the larger distances between cross members ensure excellent self-cleaning properties.

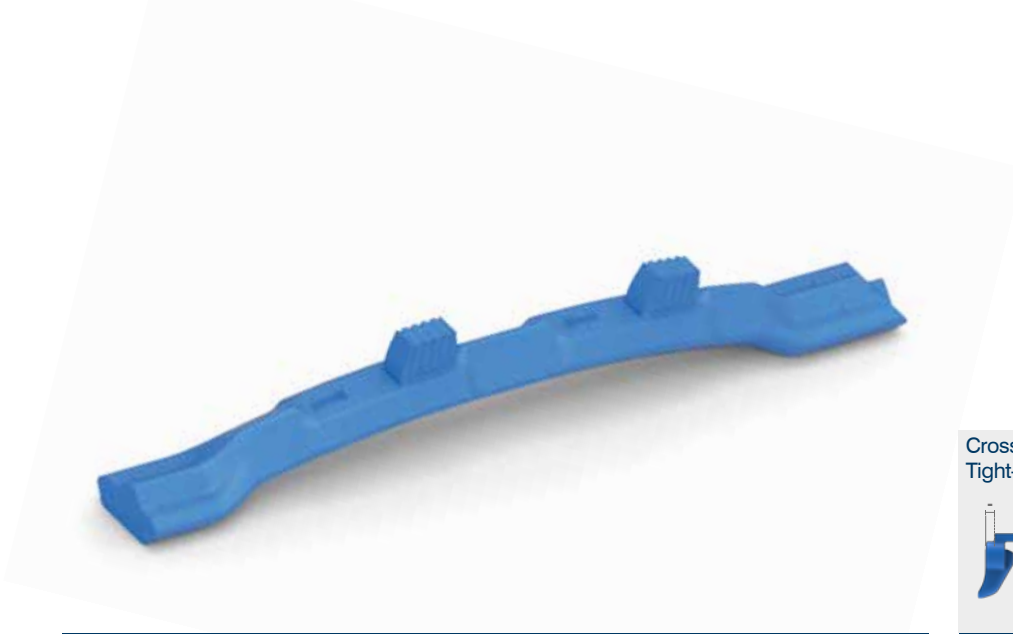

Cross member ends
Tight-Care

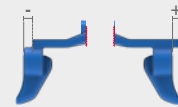

Stubs: small wave
(SW)

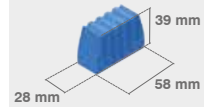

pewag practrack perfect – perfection for challenging applications

pewag perfect tracks are synonymous with the highest precision and quality in forestry applications. They were developed for reliable performance even in the toughest situations and offer outstanding lifespan and traction. Ideal for heavy machinery and complex terrain, the perfect tracks allow you to stay in control at all times.

Areas of use

Steep and rocky terrain – even in snowy and muddy conditions.



Cross member ends
Tight-Care

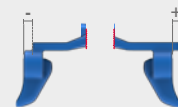

Stubs: small wave (SW)

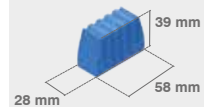

pewag practrack duro – wonderfully versatile

duro track is our “bread-and-butter” model for versatile applications, from normal working conditions to steep slopes. Their robust construction is suitable for a wide range of machines and ensures reliable performance in all kinds of conditions.

Areas of use

Universal traction for use on medium to steep terrain.



Cross member ends Tight-Care

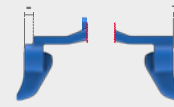

Stubs: small wave (SW)

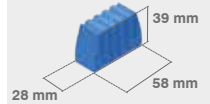

pewag practrack flow-perfect – The all-rounder that offer a synthesis of efficiency and strength

pewag flow-perfect track combine the advantages of flow tracks with the strength of perfect tracks. They are the ideal choice for a range of different operating conditions, from flat to medium and steep terrain. The tracks will protect your tyres and ensure continuous performance, without compromising on traction.

Areas of use

For all-round usage and varying terrains.

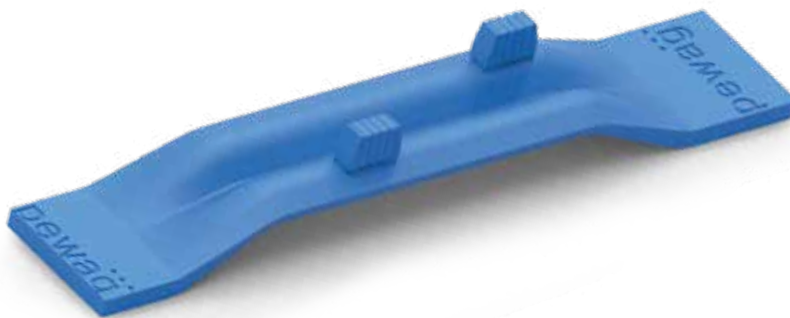

Cross member ends Tight-Care

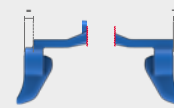

Stubs: small wave (SW)

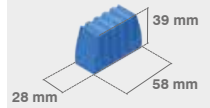

pewag practrack flow – For use on flat and soft terrain to minimise soil impact

With pewag flow track, you will master flat terrain with ease and increase your machine's efficiency at the same time. If the application range of your machine is limited, this track will significantly reduce pressure on the soil thanks to the large contact surface, thereby reducing soil impact.

Areas of use

For flat, soft terrain.

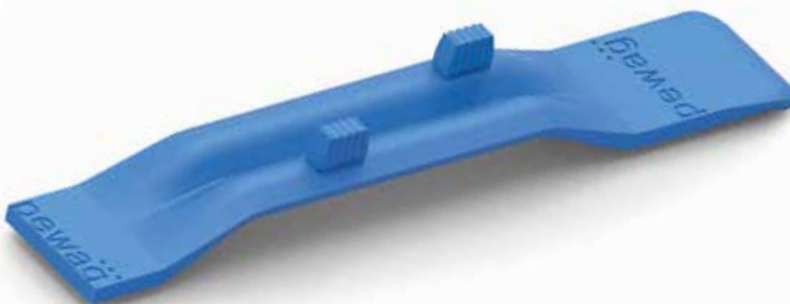

Cross member ends Tight-Wide

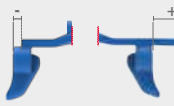

Stubs: small wave (SW)

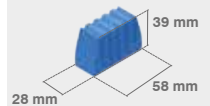

pewag practrack flow wide – Minimal soil impact, maximum stabilisation of your machine

With their extra wide contact surface, pewag flow wide tracks offer maximum stability, combined with the lowest pressure on the soil of any pewag track types. They were developed for working on soft, yielding ground and allow for safe operations on flat terrain without sinking. Ideal for operations where the focus is not on the application range of your machine.

Areas of use

Flat, swampy terrain; minimum soil impact.

pewag bluetrack for professional forestry application

The safe choice for all conditions



pewag bluetrack duro – duo with medium wave stub



pewag bluetrack duro – duo with large wave stub



Link distance: Medium (M)

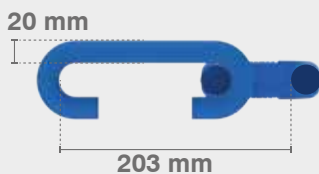

Higher wear resistance and excellent tyre protection.

starwave® stub: medium wave (MW)

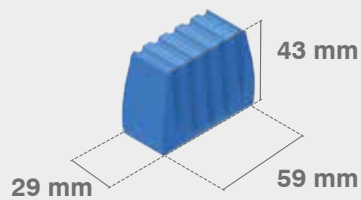

For more traction and improved wear resistance

Case-hardened

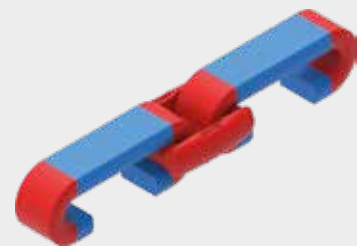

This process increases surface hardness and thus also the wear resistance of the connecting system.



bluetrack

pewag bluetrack is our most versatile all-rounder. It combines traction, excellent tyre protection and a more robust connecting system than the practrack, making them a reliable choice for professional harvesting applications. Their high level of wear resistance helps to significantly reduce downtimes. In their

standard design, they come with two offset starwave® stubs in size M, but may also be combined with larger stubs (size L) for even better traction and a longer lifespan. Thanks to its versatility, the bluetrack line is particularly popular for new machinery and OEMs.

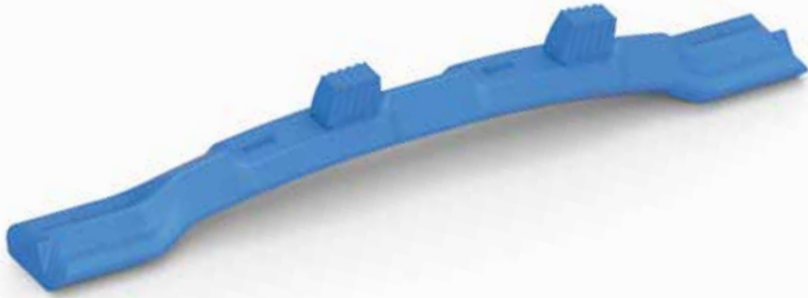

Cross member ends
Care-Care

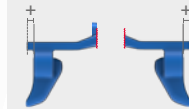

Stubs: medium
wave (MW)

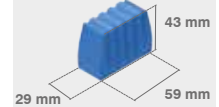

Optional
Cross member ends
Tight-Care

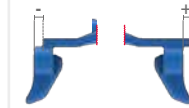

Optional Stubs:
large wave (LW)

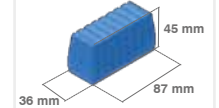

pewag bluetrack & bluetrack+ perfect – perfection for challenging applications

pewag perfect track is synonymous with highest precision and quality in forestry applications. They were developed for reliable performance even in the most toughest situations and offer outstanding lifespan and traction. Ideal for complex terrain, the perfect tracks allow you to stay in control at all times.

Areas of use

Steep and rocky terrain – even in snowy and muddy conditions.



Cross member ends
Care-Care

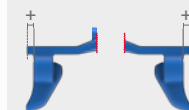

Stubs: medium
wave (MW)

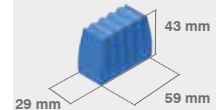

Optional
Cross member ends
Tight-Care

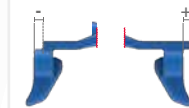

Optional Stubs:
large wave (LW)

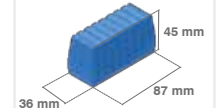

pewag bluetrack & bluetrack+ duro – wonderfully versatile

duro track is our “bread-and-butter” models for versatile applications, from normal working conditions to steep slopes. Their robust construction is suitable for a wide range of machines and ensures reliable performance in all kinds of conditions.

Areas of use

Universal traction for use on medium to steep terrain.



Cross member ends
Care-Care

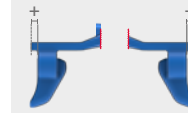

Stubs: medium wave (MW)

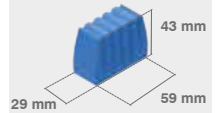

Optional
Cross member ends
Tight-Care

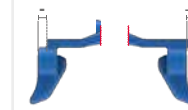

Optional Stubs:
large wave (LW)

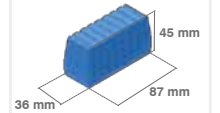

pewag bluetrack & bluetrack+ flow-perfect – The all-rounder that offers a synthesis of efficiency and strength

pewag flow-perfect track combine the advantages of flow tracks with the strength of perfect tracks. It is the ideal choice for a range of different operating conditions, from flat to medium and steep terrain. The track will protect your tyres and ensure continuous performance, without compromising on traction.

Areas of use

For all-round usage and varying terrains.

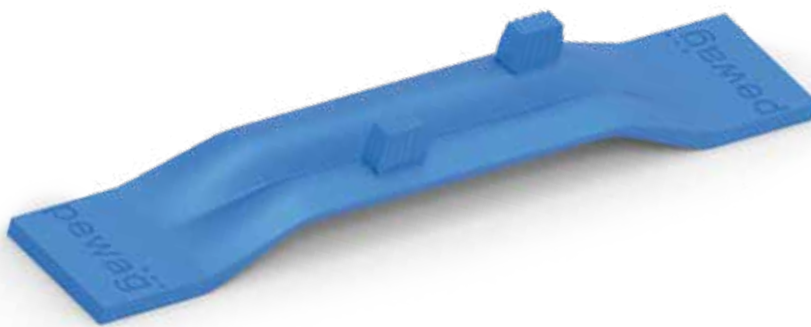

Cross member ends
Care-Care

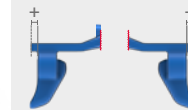

Stubs: medium wave (MW)

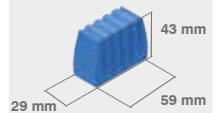

Optional
Cross member ends
Tight-Care

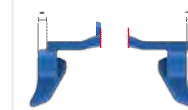

Optional Stubs:
large wave (LW)

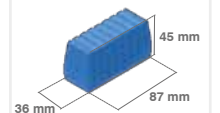

pewag bluetrack & bluetrack+ flow – For use on flat and soft terrain to minimise soil impact

With pewag flow track, you will master flat terrain with ease and increase your machine's efficiency at the same time. If the application range of your machine is limited, these tracks will significantly reduce pressure on the soil thanks to the large contact surface, thereby reducing soil impact.

Areas of use

For flat, soft terrain.

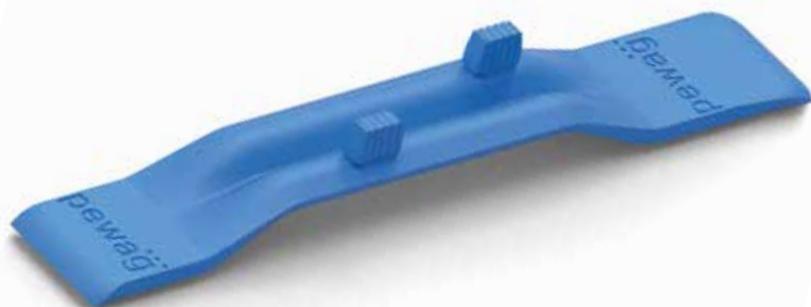

Cross member ends
Care-Wide

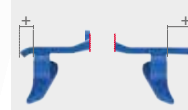

Stubs: medium wave (MW)



Optional
Cross member ends
Tight-Wide

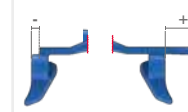

Optional Stubs:
large wave (LW)

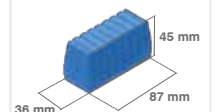

pewag bluetrack & bluetrack+ flow wide – Minimum soil impact, maximum stabilisation of your machine

With their extra wide contact surface, pewag flow wide track offer maximum stability, combined with the lowest pressure on the soil of any pewag track types. It was developed for working on soft, yielding ground and allow for safe operations on flat terrain without sinking. Ideal for operations where the focus is not on the application range of your machine.

Areas of use

Flat, swampy terrain; minimum soil impact.

pewag bluetrack+

If you're looking for even more comfort

pewag bluetrack+ represents an additional and new version of our tried-and-tested bluetracks. Thanks to the tighter arrangement of the cross members, these tracks make for an even easier and less strenuous ride and are designed for use with forwarders in particular. The heavier weight and the resulting lower centre of gravity significantly increase the stability of the machine. A larger number of cross members minimises wear and thus extends the lifespan of the tracks, which is a significant

advantage for forwarders, in particular over longer distances. In addition, bluetrack+ offer optimised tyre protection thanks to the tighter distances between cross members. The standard design comes with two starwave® stubs in size M, but the bluetrack+ product may also be fitted with size L stubs for even better traction and longer wearability, true to the bluetrack tradition with its tried-and-tested offset design.

What are the differences between bluetrack and bluetrack+?

The cross members of the bluetrack and bluetrack+ are identical and have exactly the same characteristics. Both the standard and the optional configurations are the same.

The bluetrack+ range has a shorter link system, which means that there are more cross members per track.

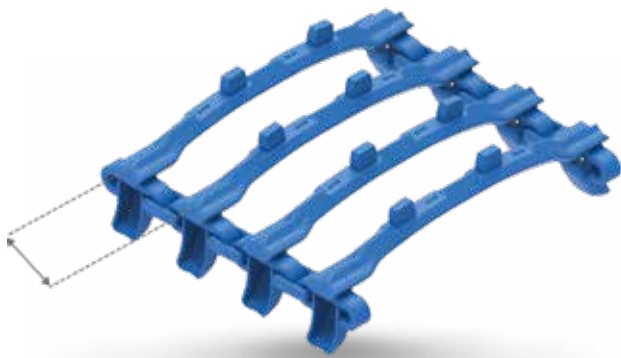

pewag bluetrack perfect – duo with medium-wave stub

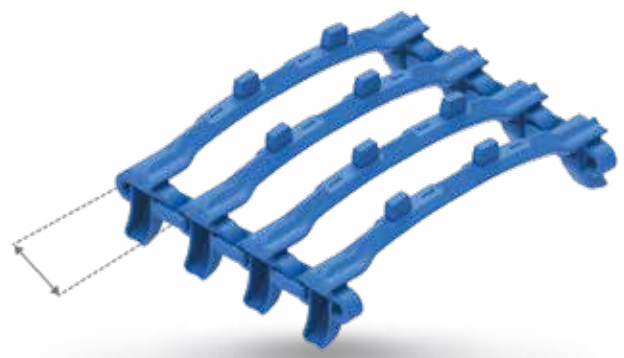

pewag bluetrack+ perfect – duo with medium-wave stub

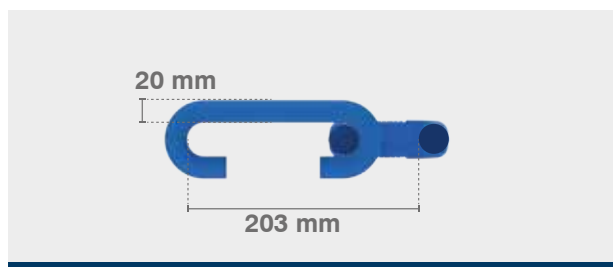

Link distance: Medium (M)

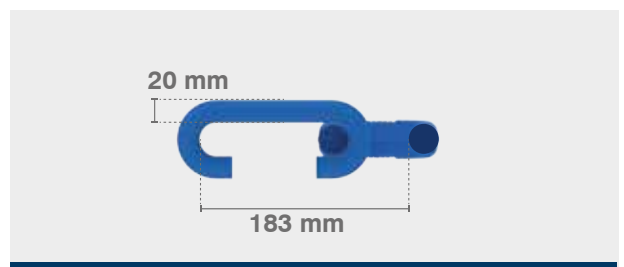

Link distance: Short (S)



pewag suptrack – Supreme quality for extreme challenges

Hardcore harvesting



pewag suptrack perfect extreme – duo



pewag suptrack perfect – duo with large-wave stub

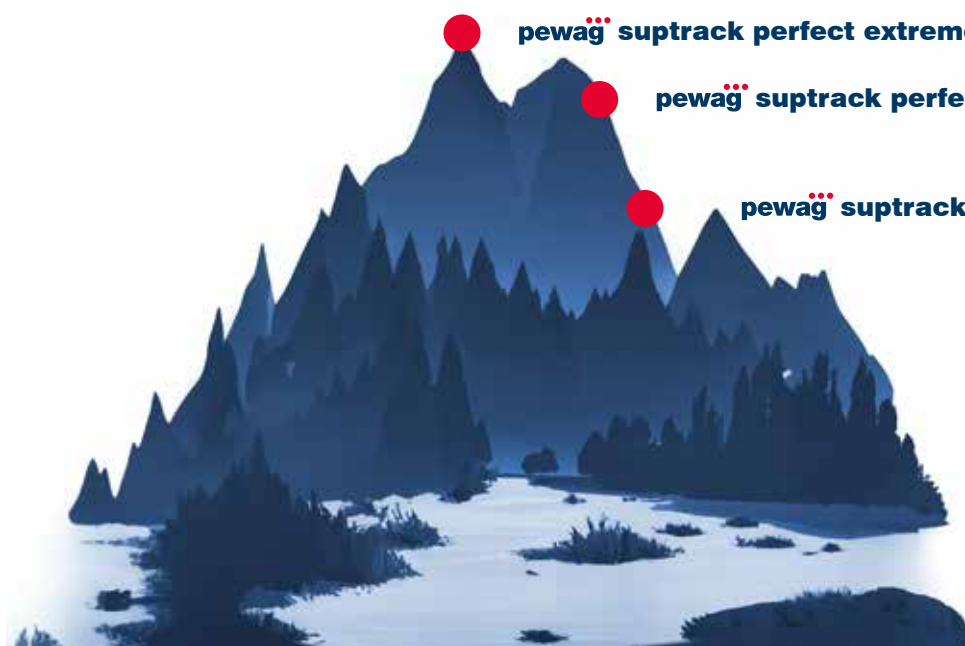

pewag suptrack perfect extreme

pewag suptrack perfect 55

pewag suptrack duro 55

Link distance: Long (L)



Higher wear resistance and excellent tyre protection.

starwave® stubs: medium wave (MW)– with the exception of perfect extreme

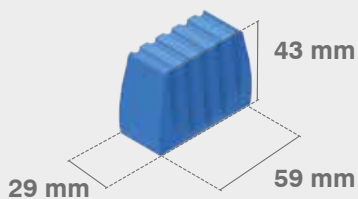

For more traction and improved wear resistance

Case-hardened

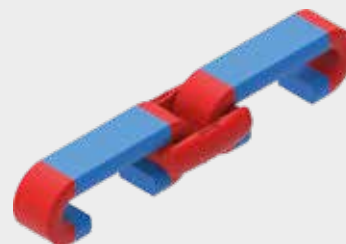

This process increases surface hardness and thus also the wear resistance of the connecting system.



suptrack

The pewag suptrack family stands out for its unique robustness. Led by the "perfect extreme" flagship product, this line was designed for the toughest conditions. The products in this family have particularly strong cross members, developed for the largest, heaviest machines and the most extreme areas of use. In

addition to the standard offset starwave® stubs in size M, there is also the option of choosing more aggressive stubs in size L to boost performance even further. The generous gap between cross members means that suptrack models have outstanding self-cleaning properties.



Cross member ends
Tight-Care

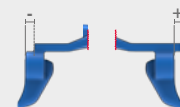

pewag suptrack perfect extreme – perfection for challenging applications

Designed specifically for use under the toughest conditions, the perfect extreme offers superior strength and durability, delivering maximum performance for the heaviest machines and the most challenging environments.





Cross member ends
Tight-Care

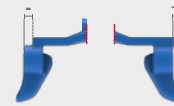

Stubs: medium
wave (MW)

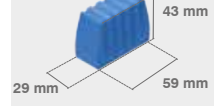

Optional Stubs:
large wave (LW)

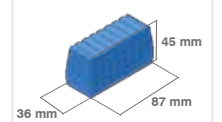

pewag suptrack perfect – even stronger

The pewag suptrack perfect tracks have all the features of the perfect products, but are even stronger thanks to the larger cross-section (55 mm instead of 50 mm), making them the perfect partners for heavy machines and tough conditions.



Cross member ends
Tight-Care

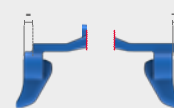

Stubs: medium
wave (MW)

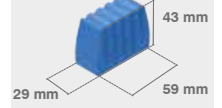

Optional Stubs:
large wave (LW)

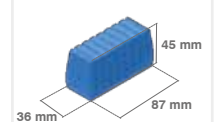

pewag suptrack duro – even stronger

The pewag suptrack duro is just as versatile as the normal duro track. Thanks to the larger cross-section (55 mm instead of 50 mm), the duro55 is even stronger, making it the perfect all-round option for heavy machinery, in any situation.

Forestry tracks

full-tree-length harvesting method



pewag mono skidder

On the safe side: The forestry track for skidders.

Developed for universal forestry operations with skidders in tough conditions.

- Increases the resistance of skidders
- Improved traction
- Effortless work, even in wet conditions or on rocky terrain



pewag mono skidder practrack

Excellent self-cleaning properties

Tyre size

23.1–26
24.5–32
28L26
30.5–32



pewag mono skidder bluetrack

Optimal tyre protection

Tyre size

23.1–26
24.5–32
28L26
30.5–32
35.5–32



pewag mono skidder suptrack

Stronger cross members

Tyre size

30.5–32
35.5–32



Forestry chains

for forestry machinery & tractors



Strong. Innovative. pewag.

State-of-the-art technologies for toughest demands.

Reliability and wear-resistance are critical elements for safe and efficient work in rough terrain.

pewag chains for forestry vehicles provide perfect self-cleaning capabilities and ensure optimum soil preservation as well as easy mounting due to their comparably lighter weight. Depending on the vehicle and tire type, pewag offers variable chain mesh shapes and chain diameters as well as customized solutions.



Mounting video

Inside/outside chain

Shoulder chain

Link with weld-on spike/stub

Shackle

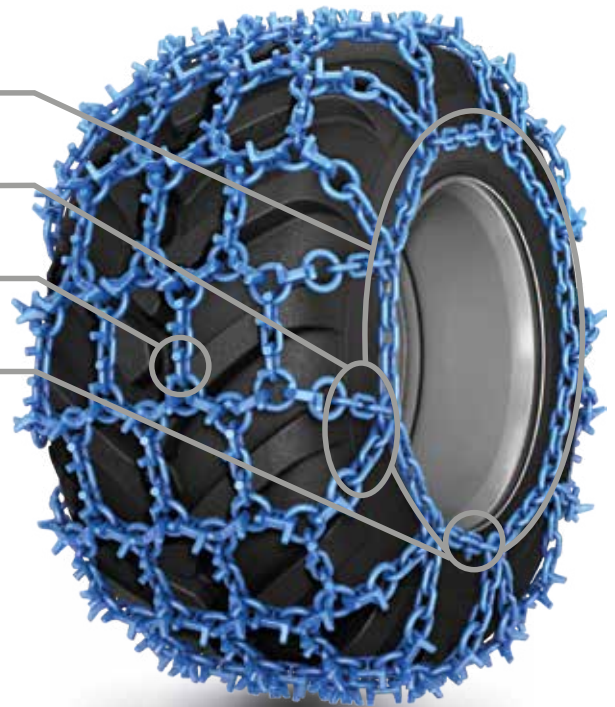

pewag forstgrip pro

Running mesh

Ring

Forged parts: spikes are arranged at an angle



pewag forstgrip pro

The pewag product range

The pewag range includes two traction chain product lines: **pewag forstgrip** and **pewag prac chain**.

pewag forstgrip is our high-end line for forestry professionals, offering the highest possible level of safety and efficiency. pewag prac chain is our go-to line and a reliable partner for all types of forest operations.

pewag forstgrip

- Superior grip and stability thanks to innovative grip elements
- Longer lifespan thanks to pewag special steel TitanGrip®
- Optimised fit of the chain on the tire
- Anti-twist protection prevents tire damage
- Superb self-cleaning properties
- Customer-focused service worldwide
- Perfected, state-of-the-art pewag forstgrip quality

pewag prac chain

- Improved grip and stability thanks to tried-and-tested grip elements
- Longer lifespan thanks to pewag special steel TitanGrip®
- Optimised fit of the chain on the tire
- Anti-twist protection prevents tire damage
- Reliable self-cleaning properties
- Welded V-bars for high grip



	forstgrip 12.5 - 3/1	forstgrip 12.5 - 3/2	forstgrip 15.5 - 6/1	forstgrip 15.5 - 6/2	forstgrip pro 13.5	forstgrip pro 15.5
Spike	✓	✓	✓	✓	✓	✓
Stub	✗	✗	✗	✗	✗	✗
Forged parts	✗	✗	✗	✗	✓	✓
Traction	■■■■■	■■■■■	■■■■■	■■■■■	■■■■■	■■■■■
Snow	■■■■■	■■■■■	■■■■■	■■■■■	■■■■■	■■■■■
Ice	■■■■■	■■■■■	■■■■■	■■■■■	■■■■■	■■■■■
Rock/stone	■■■■■	■■■■■	■■■■■	■■■■■	■■■■■	■■■■■
Clay/mud	■■■■■	■■■■■	■■■■■	■■■■■	■■■■■	■■■■■
Suitable for universal use	■■■■■	■■■■■	■■■■■	■■■■■	■■■■■	■■■■■
Gentle on the soil	■■■■■	■■■■■	■■■■■	■■■■■	■■■■■	■■■■■
Tyre coverage/tire protection	■■■■■	■■■■■	■■■■■	■■■■■	■■■■■	■■■■■
Chain thickness	12.5	12.5	15.5	15.5	13.5	15.5
Ring thickness	15.2	15.2	17	17	15.2	17



Self-cleaning properties and grip: The classic among forestry chains.

Developed for soft and muddy terrain – even for snowy conditions.

With pewag forstgrip you will benefit from ...

- ... uninterrupted driving thanks to the excellent self-cleaning properties of the wide mesh design.
- ... optimised grip and stability of the forestry machine even on rough terrain thanks to the angled stub arrangement.

Product design

- 12.5 mm (ring 15.2 mm) – all-round model for all terrains and forestry machines.
- 15.5 mm (ring 17 mm) – wide-meshed chain, particularly suitable for soft soil and large forestry machines such as forwarders and harvesters, also thanks to its excellent self-cleaning properties.

Depending on the material strength and chain, the product is available in a one- or two-field design.



Product page

Matrix pewag forstgrip

	forstgrip 12.5 – 3/1	forstgrip 12.5 – 3/2	forstgrip 15.5 – 6/1	forstgrip 15.5 – 6/2
Spike	✓	✓	✓	✓
Stub	x	x	x	x
Forged parts	x	x	x	x
Traction	■■■■■■■■■■	■■■■■■■■■■	■■■■■■■■■■	■■■■■■■■■■
Snow	■■■■■■■■■■	■■■■■■■■■■	■■■■■■■■■■	■■■■■■■■■■
Ice	■■■■■■■■■■	■■■■■■■■■■	■■■■■■■■■■	■■■■■■■■■■
Rock/stone	■■■■■■■■■■	■■■■■■■■■■	■■■■■■■■■■	■■■■■■■■■■
Clay/mud	■■■■■■■■■■	■■■■■■■■■■	■■■■■■■■■■	■■■■■■■■■■
Suitable for universal use	■■■■■■■■■■	■■■■■■■■■■	■■■■■■■■■■	■■■■■■■■■■
Gentle on the soil	■■■■■■■■■■	■■■■■■■■■■	■■■■■■■■■■	■■■■■■■■■■
Tire coverage/tire protection	■■■■■■■■■■	■■■■■■■■■■	■■■■■■■■■■	■■■■■■■■■■
Chain thickness	12.5	12.5	15.5	15.5
Ring thickness	15.2	15.2	17	17

pewag forstgrip pro

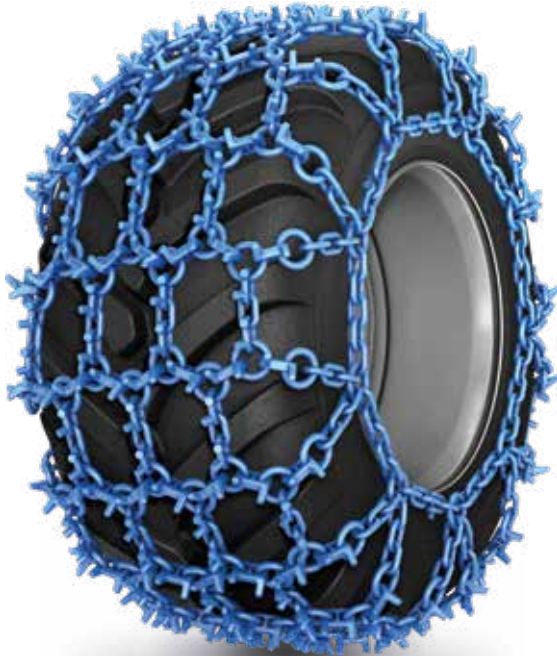

Grip, stability and protection: The forestry chain pro for rough terrain.

Developed for hard, rocky terrain and icy conditions.

With pewag forstgrip pro you will benefit from ...

- ... safe operation and optimised grip thanks to combination of forged parts and spikes.
- ... optimised protection of the tire against damage caused by tree stumps and stones thanks to the fine mesh.
- ... optimised grip and stability of the forestry machine on rough terrain thanks to angled stub arrangement.

Product design

- 13.5 mm (ring 15.2 mm) – all-rounder model, suitable for hard grounds and all forestry machines.
- 15.5 mm (ring 17 mm) – strong, wide chain mesh for both for hard and soft grounds and especially for large forestry machines such as forwarders and harvesters.



Product page

Matrix pewag forstgrip pro

	forstgrip pro 13.5	forstgrip pro 15.5
Spike	✓	✓
Stub	✗	✗
Forged parts	✓	✓
Traction	■■■■■	■■■■■■■
Snow	■■■■	■■■■■
Ice	■■■■■	■■■■■
Rock/stone	■■■■■	■■■■■■■
Clay/mud	■■■■	■■■■■
Suitable for universal use	■■■■■	■■■■■
Gentle on the soil	■■■■	■■■■
Tire coverage/tire protection	■■■■■	■■■■■
Chain thickness	13.5	15.5
Ring thickness	15.2	17

pewag forstgrip cross



The forest crossover – the universal chain made by pewag.

Developed for a wide range of different applications and terrains.

With pewag forstgrip cross, you will benefit from ...

- ... universal application profile especially for large forestry machines and changing ground conditions.
- ... long lifespan thanks to high resilience and wear resistance.
- ... optimised grip and stability of the forestry machine on rough terrain thanks to various forged parts.
- ... excellent self-cleaning properties on soft ground thanks to the wide chain mesh.

Product design

- The chain mesh consists of forged elements and rings (15.2 mm).
- Only available in a one-field design.

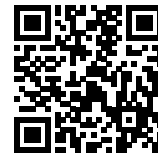

Product page

Matrix pewag forstgrip cross

	forstgrip cross
Spike	✓
Stub	x
Forged parts	✓
Traction	██████████
Snow	██████████
Ice	██████████
Rock/stone	██████████
Clay/mud	██████████
Suitable for universal use	██████████
Gentle on the soil	░░░░░░░░
Tire coverage/tire protection	█░░░░░░░
Chain thickness	-
Ring thickness	15.2

pewag forstgrip soft



Gentle on the soil, strong grip: The logging road-friendly pewag forestry chain.

Developed for practical use on logging roads and terrain.

With pewag forstgrip soft you will benefit from ...

- ... uninterrupted, soil-friendly driving on logging roads and off-road also with heavy forestry machinery.
- ... good traction with reduced soil damage thanks to a running mesh made from forged elements with a stub-free geometry that is gentle on the soil.
- ... excellent self-cleaning properties on soft ground thanks to the wide-chain mesh.
- ... particularly gentle on the tire thanks to even distribution of pressure.

Product design

- The chain mesh consists of forged elements and rings (15.2 mm).
- Only available in a one-field design.



Product page

Matrix pewag forstgrip soft

	forstgrip soft
Spike	x
Stub	x
Forged parts	✓
Traction	██████████
Snow	██████████
Ice	██████████
Rock/stone	██████████
Clay/mud	██████████
Suitable for universal use	██████████
Gentle on the soil	██████████
Tire coverage/tire protection	██████████
Chain thickness	-
Ring thickness	15.2

pewag forstgrip pro soft



Tougher than the rest – the master on solid ground.

Developed for rough terrain with additional tire protection and also suitable for logging roads.

With pewag forstgrip pro soft you will benefit from ...

- ... uninterrupted, soil-friendly driving on logging roads and on hard, rocky terrain also with heavy forestry machinery.
- ... good traction with improved soil protection thanks to shortened stubs.
- ... excellent self-cleaning properties on soft ground thanks to the fine three-field chain mesh.
- ... particularly gentle on the tire thanks to even distribution of pressure and rounded forged parts.

Product design

- 12.5 mm (ring 15.2 mm) – all-rounder for hard grounds and all forestry machines.



Product page

Matrix pewag forstgrip pro soft

	forstgrip pro soft 12.5
Spike	x
Stub	✓
Forged parts	✓
Traction	██████████
Snow	██████
Ice	██████
Rock/stone	██████████
Clay/mud	██████
Suitable for universal use	██████
Gentle on the soil	██████
Tire coverage/tire protection	██████
Chain thickness	12.5
Ring thickness	15.2

pewag[®] prac chain



Strong stubs: The sensible partner for hands-on applications.

Developed for heavy forestry applications, including clay, mud, and ice.

With the pewag prac chain, you will benefit from ...

- ... improved traction also on soft soil thanks to stubs with starwave[®] profile.
- ... optimised grip and stability also with heavy forestry machinery on difficult terrain.
- ... uninterrupted driving thanks to reliable self-cleaning properties of the wide chain mesh.



Product page



prac chain 16



prac chain 18

Matrix pewag prac chain

	pewag prac chain 16	pewag prac chain 18
Spike	✓	✓
Stub	x	x
Forged parts	x	x
Traction	██████░░	██████░░
Snow	██████░░	██████░░
Ice	████████░	████████░
Rock/stone	██████░░	██████░░
Clay/mud	████████░	████████░
Suitable for universal use	██████░░	██████░░
Gentle on the soil	░░░░░░░░	░░░░░░░░
Tire coverage/tire protection	████░░░░	████░░░░
Chain thickness	15.5	17.5
Ring thickness	17	17



KA/24/00584



www.pewag.com/en/

pewag Schneeketten GmbH

A-9371 Brückl, Kettenwerk 1, Tel.: +43 (0) 50 50 11-299, Fax: +43 (0) 50 50 11-100
forestry@pewag.com, www.pewag.com/de/

